



making work easy



de

en

fr

it

es

pt

tr

ru

pl

ja

ko

ar

da

fi

no

sv

# LIGHT 1

Quick Start Guide

Made in Germany

21-6028 11122024

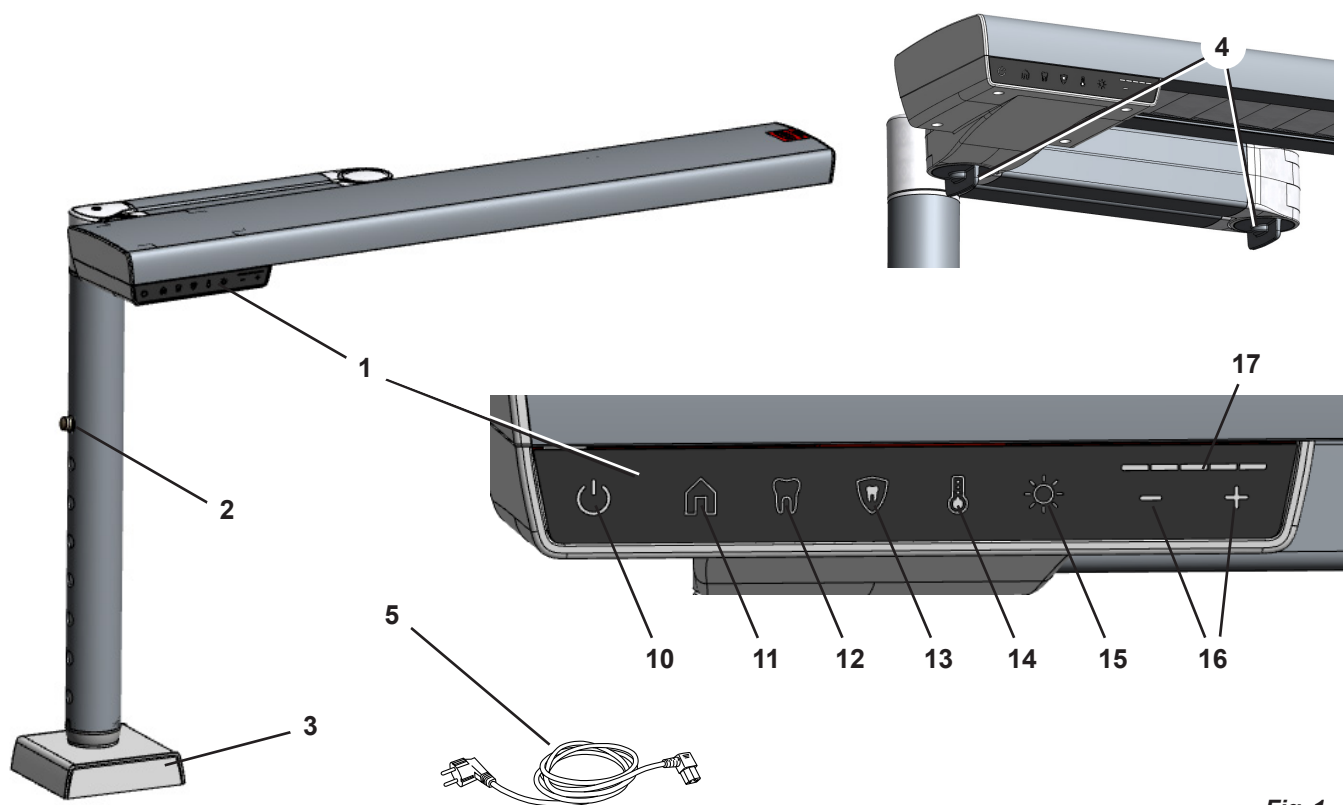

Fig. 1

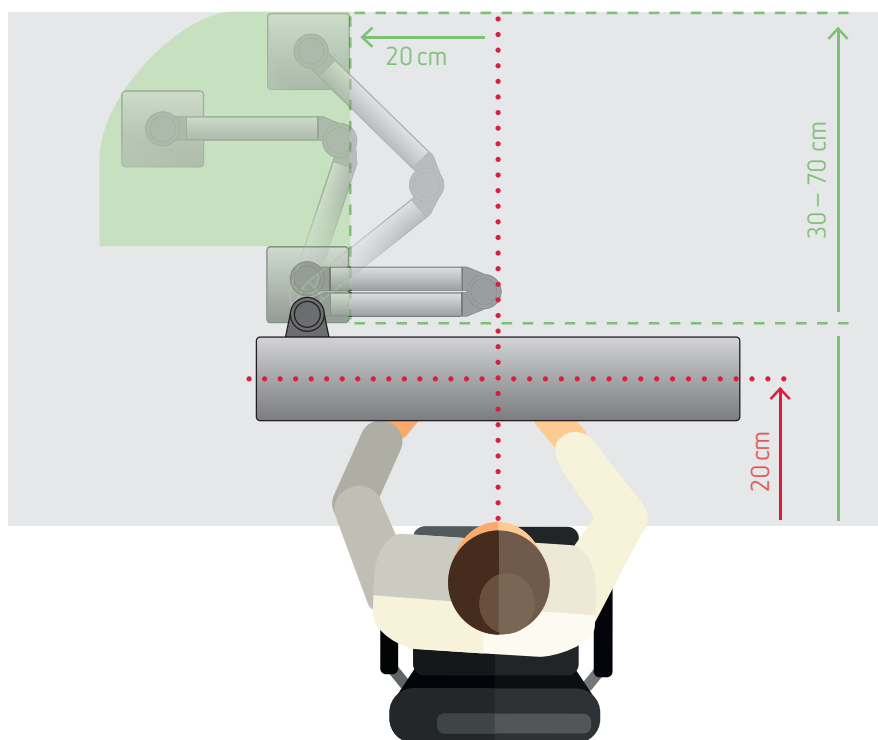

Fig. 2

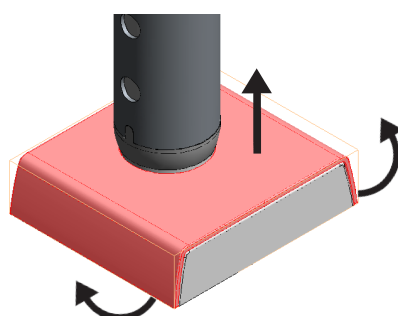

Fig. 3

# Online help and information

[www.renfert.com/25000600](http://www.renfert.com/25000600)



en

Here you will find the following documents and information for download:

- Operating Instructions
- Quick Start Guide
- Spare parts lists and spare parts drawings
- Maintenance manual
- FAQs, cause and rectification of faults
- How to - Videos
- Declarations of conformity

Please note: The documents and information listed are not available for all products.

## Symbols used

Symbols with the following meanings are used in these instructions or on the product:



### **Danger**

**Immediate risk of injury. Consult accompanying documents!**



### **Electrical voltage**

**Danger due to electrical voltage.**



### **Caution**

**Risk of damage to the product if the instruction is not followed.**



### **Note**

**Provides the operator with useful information that eases use.**



**The product complies with applicable EU directives.**



**The product is subject to the provisions of the EU directive 2002/96/EC (WEEE directive).**

Other symbols are explained as they occur.

## Safety

---

### ***Intended use***

The purpose of this product is to provide lighting for a dental technical workplace. It is not intended for general lighting.

---

### ***Meaning of these instructions***

These instructions for use act as a guide for safe usage of the product.

If the instructions for use are not observed, accidents may lead to life-threatening electric shock, injury, or damage.

- ⇒ Only use the product in accordance with these instructions for use.
- ⇒ Keep the instructions for use ready with the product.
- ⇒ Provide the instructions for use to all subsequent users of the product.

---

### ***Requirements that the operator must meet***

- ⇒ The product may only be used by persons aged 14 or over who are familiar with the procedures and rules in a dental laboratory and have been instructed on how to use the product.

---

### ***Safe condition of the product***

**Faulty or broken components, or those that are not sealed as required, may cause injuries.**

- ⇒ Check the power cord, housing, and other components such as connection cables, tubes, and the key pad for damage, for example such as kinks, cracks, porosity, and signs of aging.

⇒ Defective products must be taken out of service immediately. Disconnect the power plug. Send the product in for repair or dispose of it safely. Until this happens, secure the product to prevent it from being switched on again so that it is not used inadvertently.

⇒ Do not expose the product to mechanical impact. Do not drop it.

### ***Risks as a result of modifications and repairs***

**Incorrect modifications and repairs to the product may cause accidents, fire, and electric shock.**

⇒ Only have the product repaired by qualified specialist dealers or return it.

### ***Risk as a result of electric shock and fire***

**Risk of electric shock and of fire as a result of excessive operating voltage or if there is no protective conductor.**

⇒ Ensure that the power plug is easily accessible.

⇒ Only operate the product using a power cord equipped with a plug appropriate to the local power supply. Only allow qualified electricians to modify power cords.

⇒ Only switch on the product if the information on the nameplate matches the power supply.

⇒ Only connect the product to electrical sockets that are connected to the protective conductor system.

### ***Risk of injury to the eyes or skin***

**Risk of glare!**

⇒ Do not look directly into the light!

**Danger of burns!**

**The surface of the workbench light heats up during operation.**

⇒ Hold the light by the sides to adjust it!

## **Product description**

### **Assemblies and functional elements**

See Fig. 1 (on inside cover)

- |                                               |                                                                               |
|-----------------------------------------------|-------------------------------------------------------------------------------|
| <b>1</b> Control panel                        | temperature and brightness)                                                   |
| <b>2</b> Height adjustment / lock             | <b>13</b> Composite mode (preset values for color temperature and brightness) |
| <b>3</b> Model base (Socket)                  | <b>14</b> Color temperature                                                   |
| <b>4</b> Joint lock                           | <b>15</b> Brightness                                                          |
| <b>5</b> Power cord                           | <b>16</b> Plus/minus button, increases/decreases the value                    |
| <b>10</b> Power                               | <b>17</b> Intensity (for brightness and color temperature)                    |
| <b>11</b> Home                                |                                                                               |
| <b>12</b> Shade mode (preset values for color |                                                                               |

### **Scope of delivery**

- 1 Workbench light LIGHT 1
- 1 Power cord
- 4 Universal screws: 6x35-T30 (2500 0600 only)
- 4 Universal dowels: 8x40 (2500 0700 only)
- 4 Screws: 4.5x45-T25 (2500 0700 only)
- 4 Washer and Cover caps (2500 0700 only)
- 1 Angle screwdriver T25 (2500 0700 only)
- 1 Quick Start Guide
- 1 Drilling template

# Startup

## Setup

⇒ Choose an installation location where the power plug can be accessed easily.



**You need at least two people to attach the workbench light!**

### Optimal position of the workbench light

Tests have shown that the best illumination of the workplace results when the workbench light is placed approx. 200 mm within the workplace, measured from the front edge of the table top to the center line of the workbench light, see Fig. 2.

### Attachment to a workbench (2500 0600)



**A Torx screwdriver (size T30) is required for the universal screws.**

⇒ Press in the height adjustment lock (2, Fig. 1) and pull out the inner tube on the base to the maximum position.

⇒ On the left and right, turn the cover up slightly and push upwards (Fig. 3).

⇒ Identify a suitable attachment location on the workbench.



**To determine the suitable mounting location, loosen the joint lock (4, Fig. 1) and check that you can move the workbench light to the optimal position described previously.**

⇒ Place the workbench light where you want to attach it and hold in position.

⇒ Using the screws provided, secure the base to the workbench.

⇒ Clip the cover onto the base again.



**If the power cord is to be routed through the table top, use the "Table" drill template provided to drill the hole for the power cord through the table top.**



**To route the power cord through the table top, the attached power plug must be removed and then reattached.**

**This work must be completed by a qualified electrician!**

### Attachment to a wall (2500 0700)



**Caution!**

**The wall must be sufficiently stable to allow for attachment of the workbench light.**

**Attachment to dry wall panels (plaster board) is not permitted.**



**4 universal dowels and 4 screws are provided for attachment to the wall.**

**You may need to use special dowels for certain walls.**



**When choosing an attachment location, you must take the following into consideration:**

- ▶ The height of the workbench light for wall attachment cannot be adjusted!
  - ▶ The recommended distance to the worktop is 600 mm.
  - ▶ The workplace light can be moved to the optimal position described above.
- ⇒ Ensure that there are no electrical cables or water pipes at the selected location in the wall.
- ⇒ Use the "wall" drill template provided to determine the position of the holes for the fastening screws.
- ⇒ Drill holes to match the dowels used. Insert the dowels.
- ⇒ Route the power cord through the groove (21) in the wall plate.
- ⇒ Hold the workbench light with the wall plate against the wall and screw into place.

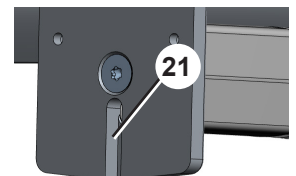

### Electrical connection



**Note the instructions in chapter risk as a result of electric shock and fire!**

⇒ Plug the power cord into the cable plug on the base of the workbench light.

⇒ Insert the power plug into a building electrical socket.

# Operation

The LIGHT 1 workbench light offers 3 modes with preset values for brightness and color temperature as well as a standard mode.

- Standard mode: The values for brightness and color temperature can be adjusted individually.
- Home (11): The values saved in this mode for brightness and color temperature can be adjusted and saved again for home mode.
- Shade mode / tooth shade determination (12): The values saved in this mode are aligned with the DG-ZMK statement (German Association for Dental, Oral and Maxillofacial Medicine) on determining tooth shade and can not be changed.
- Composite mode (13): This pre-defined mode allows the processing time of light-curing composite materials to be extended and can not be changed.

## Switching on / off

⇒ Press the power button (10) briefly

- ♦ The workbench light is switched on.
- ♦ The mode that was active when switching off the last time is set again:
- ♦ The brightness button (15) lights up.
- ♦ A corresponding mode button may also light up.
- ♦ The current brightness value is displayed in the intensity display (17).

⇒ Press the power button (10)

- ♦ The current settings are saved.
- ♦ The workbench light is switched off.

## Selecting the mode

⇒ Press the button for the required mode (11, 12, or 13).

- ♦ The button for the selected mode lights up.

## Setting brightness

The brightness can be changed directly in all modes.

- ♦ The current brightness value is displayed in the intensity display (17).

⇒ Set the value as required using the plus/minus buttons (16).

- ♦ The lighting of the button for a selected mode is switched off.

## Setting the color temperature

⇒ Press the color temperature button (14).

- ♦ The color temperature button (14) lights up.
- ♦ The current color temperature value is displayed in the intensity display (17).

⇒ Set the value as required using the plus/minus buttons (16).

- ♦ This switches back automatically to the brightness setting after approx. 5 seconds.

## Saving values for the home button

The values used with the home button for brightness and color temperature can be adjusted and saved again.

⇒ Set brightness and color temperature as described previously.

⇒ Press and hold the home button (11) for longer than 2 seconds.

- ♦ The current values for brightness and color temperature are saved.
- ♦ The intensity display (17) flashes, providing visual confirmation of the save action.

## Adjusting the workbench light

### Height adjustment



**When adjusting the height, ensure a distance of at least 300 mm between the underside of the workbench light and the flame of any burner placed underneath it!**

⇒ Grip the column.

⇒ Press the height adjustment lock (2) inwards.

- ⇒ Move the column up / down.
- ⇒ Allow the lock to pop out again in the new position.
- The recommended distance to the worktop is 600 mm.

### Moving

- ⇒ Release the joint lock (4).
- ⇒ Move the workbench light to the required position.
- ⇒ Tighten the joint lock again.

## Cleaning / Maintenance



**Before cleaning and maintenance work:**

- Switch off the unit and disconnect the power plug!
- Allow the unit to cool down properly!

### Cleaning



**Do not steam clean the unit under any circumstances.**

- ⇒ Clean the outside of the workbench light with a soft, dry cloth.
- ⇒ Do not use solvent-based, acidic or abrasive cleaners.

### Cleaning the cover plate

The cover plate in front of the lamp can be pulled out to the side for cleaning after removing the cover on the right.

For details, see the complete instructions online.

### Replacing a lamp

The lamp can be replaced.

Lamps may only be replaced by a qualified electrician.

### Spare parts



**Only use accessories and spare parts that have been supplied or approved by Renfert GmbH. Using other accessories or other spare parts can lead to inadvertent accidents and damage.**

You can find wear parts and spare parts in the spare parts list available online, see chapter "Online help and information".

The components excluded from the warranty (wear parts, consumables) are marked in the spare parts list.

The serial number, date of manufacturing and equipment version are shown on the nameplate of the equipment.

## Obligations regarding information

- Information on REACH and SVHC is available on our website at [www.renfert.com](http://www.renfert.com), in the Support area.

### Disposal information for countries in the EU



**The equipment must be disposed of by a specialist facility. The specialist facility must be informed of any residue in the equipment that is harmful to health.**



**For this reason, equipment with this symbol may not be disposed of in unsorted domestic waste within the European Union.**

Please contact your local authorities for more information on proper disposal.

You can find out about the current options for return online at [www.renfert.com](http://www.renfert.com)





**EG-Konformitätserklärung****DE****Renfert GmbH, Industriegebiet, 78247 Hilzingen / Germany**

Hiermit erklären wir, dass das Produkt

**LIGHT 1**

allen einschlägigen Bestimmungen der folgenden Richtlinien entspricht:

2014/35/EU (Niederspannungsrichtlinie)

2014/30/EU (EMV Richtlinie)

2011/65/EU (RoHS)

2009/125/EG(Öko-Design)

Folgende harmonisierte Normen wurden angewendet:

EN IEC 60598-1:2021, +A11:2022, EN 60598-2-1:1989, EN

61347-1: 2015, EN 61347-2-13: 2014, EN 62493: 2010,

EN IEC 55015: 2019, + A11: 2020, EN 61547: 2009, EN

62471: 2008, EN IEC 63000: 2018

Bevollmächtigt für das

Hans Peter Jilg

Zusammenstellen der technischen

c/o Renfert GmbH

Unterlagen:



Tilo Burgbacher,

Leiter Konstruktion und Geräteentwicklung

Hilzingen, 15.07.2024

**EC Declaration of conformity****EN****Renfert GmbH, Industriegebiet, 78247 Hilzingen / Germany**

Herewith we declare that the product

**LIGHT 1**

is in compliance with the relevant requirements in the following directives:

2014/35/EU (Low voltage equipment)

2014/30/EU (Electromagnetic compatibility)

2011/65/EU (RoHS)

2009/125/EC(Eco-Design)

Harmonized specifications applied:

EN IEC 60598-1:2021, +A11:2022, EN 60598-2-1:1989, EN

61347-1: 2015, EN 61347-2-13: 2014, EN 62493: 2010,

EN IEC 55015: 2019, + A11: 2020, EN 61547: 2009, EN

62471: 2008, EN IEC 63000: 2018

Authorised to compile the technical documentation:

Hans Peter Jilg

c/o Renfert GmbH



Tilo Burgbacher,

Engineering Director

Hilzingen, 15.07.2024

**Déclaration de conformité CE****FR****Renfert GmbH, Industriegebiet, 78247 Hilzingen / Germany**

Par la présente, nous certifions que le produit

**LIGHT 1**

est conforme à toutes les prescriptions applicables aux les directives européennes suivantes :

2014/35/UE (relative aux basses tensions)

2014/30/UE (relative à la compatibilité électromagnétique)

2011/65/UE (RoHS)

2009/125/EC(Eco-Design)

Normes harmonisées appliquées:

EN IEC 60598-1:2021, +A11:2022, EN 60598-2-1:1989, EN

61347-1: 2015, EN 61347-2-13: 2014, EN 62493: 2010,

EN IEC 55015: 2019, + A11: 2020, EN 61547: 2009, EN

62471: 2008, EN IEC 63000: 2018

Mandataire pour la composition de la documentation technique:

Hans Peter Jilg

c/o Renfert GmbH

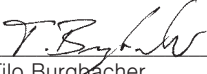

Tilo Burgbacher,

Chef du bureau d'études

Hilzingen, 15.07.2024

**Dichiarazione di conformità CE****IT****Renfert GmbH, Industriegebiet, 78247 Hilzingen / Germany**

Con la presente dichiariamo che il prodotto

**LIGHT 1**

è conforme alle seguenti direttive europee:

2014/35/UE (direttiva bassa tensione)

2014/30/UE (direttiva compatibilità elettromagnetica)

2011/65/UE (RoHS)

2009/125/EC(Eco-Design)

Le seguenti norme armonizzate sono state applicate:

EN IEC 60598-1:2021, +A11:2022, EN 60598-2-1:1989, EN

61347-1: 2015, EN 61347-2-13: 2014, EN 62493: 2010,

EN IEC 55015: 2019, + A11: 2020, EN 61547: 2009, EN

62471: 2008, EN IEC 63000: 2018

Mandatario per la composizione della documentazione tecnica:

Hans Peter Jilg

c/o Renfert GmbH

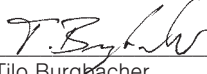

Tilo Burgbacher,

Capo reparto costruzione e sviluppo apparecchi

Hilzingen, 15.07.2024

**Declaración de Conformidad CE****ES****Renfert GmbH, Industriegebiet, 78247 Hilzingen / Alemania**

Por la presente declaramos que el producto

**LIGHT 1**

con las disposiciones pertinentes de las siguientes directivas:

2014/35/UE (Directiva de Baja Tensión)

2014/30/UE (Directiva de Compatibilidad Electromagnética)

2011/65/UE (RoHS)

2009/125/EC(Eco-Design)

Se ha cumplido con las siguientes normas armonizadas:

EN IEC 60598-1:2021, +A11:2022, EN 60598-2-1:1989, EN

61347-1: 2015, EN 61347-2-13: 2014, EN 62493: 2010,

EN IEC 55015: 2019, + A11: 2020, EN 61547: 2009, EN

62471: 2008, EN IEC 63000: 2018

Persona autorizada para elaborar el expediente técnico:

Hans Peter Jilg

c/o Renfert GmbH

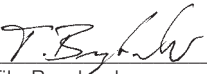

Tilo Burgbacher,

Director de Construcción y Desarrollo de Maquinaria

Hilzingen, el 15.07.2024

**Declaração CE de conformidade****PT****Renfert GmbH, Industriegebiet, 78247 Hilzingen / Germany**

Declaramos que o produto

**LIGHT 1**

corresponde às seguintes Directivas Europeias:

2014/35/UE (Directiva de baixa tensão)

2014/30/UE (Directiva CEM)

2011/65/UE (RoHS)

2009/125/EC(Eco-Design)

cumpre todas as determinações correspondentes das seguintes directivas:

EN IEC 60598-1:2021, +A11:2022, EN 60598-2-1:1989, EN

61347-1: 2015, EN 61347-2-13: 2014, EN 62493: 2010,

EN IEC 55015: 2019, + A11: 2020, EN 61547: 2009, EN

62471: 2008, EN IEC 63000: 2018

Responsável pela compilação dos documentos técnicos:

Hans Peter Jilg

c/o Renfert GmbH



Tilo Burgbacher,

Director de construção e desenvolvimento de aparelhos

Hilzingen, a 15/07/2024

# Technical Data

Item number:	2500 0600	2500 0700
Nominal voltage / VAC:	100 - 240	
Permissible mains voltage / VAC:	100 - 240	
Mains frequency / Hz:	50 / 60	
Power consumption / W:	53	
Dimensions		
Min. (retracted) (width x height x depth) / mm [inch]:	655 x 460 x 235 [25.8 x 18.1 x 9.3]	660 x 88 x 310 [26.0 x 3.5 x 12.2]
Max. (extended) (width x height x depth) / mm [inch]:	655 x 625 x 660 [25.8 x 24.6 x 26]	660 x 88 x 515 [26.0 x 3.5 x 20.3]
Weight / kg [lbs.]:	3,7 [8.16]	2,9 [6.39]
Useful luminous flux, max. (lm):	3250	
Color temperature (K), approx.:	3000 - 6000	
UGR value:	19	
Energy efficiency class of the light source provided:	A+	
Ambient conditions for safe operation		
Ambient conditions:	Indoors	
Ambient temperature; ta / °C [F]:	35 [95]	
Ambient conditions for storage and transport		
Ambient temperature	- 20 to + 60 °C [- 4 to + 140 °F]	
Maximum relative humidity	80 %	

**Hochaktuell und ausführlich auf ...**  
**Up to date and in detail at ...**  
**Actualisé et détaillé sous ...**  
**Aggiornato e dettagliato su ...**  
**La máxima actualidad y detalle en ...**  
**Актуально и подробно на ...**

**[www.renfert.com](http://www.renfert.com)**

Renfert GmbH • Untere Gießwiesen 2 • 78247 Hilzingen/Germany  
Tel.: +49 7731 82 08-0 • Fax: +49 7731 82 08-70  
[www.renfert.com](http://www.renfert.com) • [info@renfert.com](mailto:info@renfert.com)

Renfert USA • 3718 Illinois Avenue • St. Charles IL 60174/USA  
Tel.: +1 6307 62 18 03 • Fax: +1 6307 62 97 87  
[www.renfert.com](http://www.renfert.com) • [info@renfertusa.com](mailto:info@renfertusa.com)  
USA: Free call 800 336 7422